



SX 76 / 62

2022

TRIO
YACHTING YOUR LIFE

SANLORENZO

Costruttore/Builder	Sanlorenzo
Modello/Model	SX 76- 62
Anno di Costruzione/Year Build	2022
Lunghezza fuori tutto/Length overall	23,75 m
Larghezza/Beam	6,6 m
Visibile a/Lying in	Göcek/ TR
Bandiera/Flag	TC
Materiale scafo/Hull material	GRP
Motori/Engines	Volvo
Potenza motori/Engines power	2 x IPS 1200 hp
Ore Motori/Engine Hours (05.10.2022)	240 hrs
Velocità Massima/ Max Speed	22 kn
Velocità di Crociera / Cruise Speed	18 kn
Generatori/Generators	2 x 28 kW KOHLER
Ore generatori/Generators hours (05.10.2022)	Generator DX: 592 hrs / Generator SX: 590 hrs
Prezzo/Price	4.500.000 Euro
IVA/VAT	IVA pagata / Turkish VAT paid

HIGHLIGHTS

2022 Model, used for 4 months only

Still under builder's warranty

Only private use, zero charter history

In brand new condition,

Ready-to-cruise,

Only 240 hours on engines and 590 hours on gen-sets,

Listing Price: 4.700.000 Euro

4.500.000 Euro









































Master stateroom



Master stateroom



Master stateroom



Master bathroom





Guest cabin



Guest cabin bathroom



2nd guest cabin

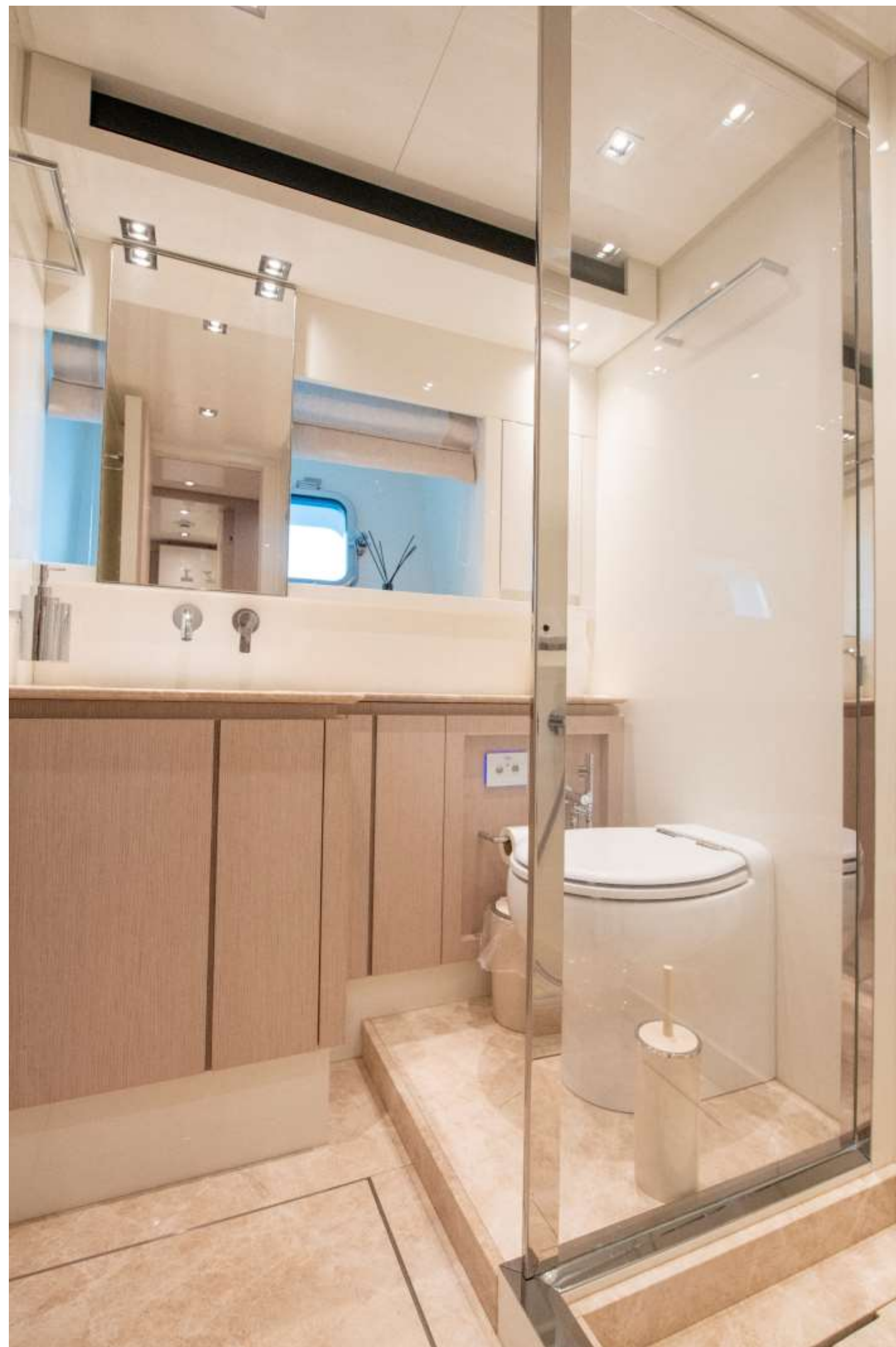







Crew cabin













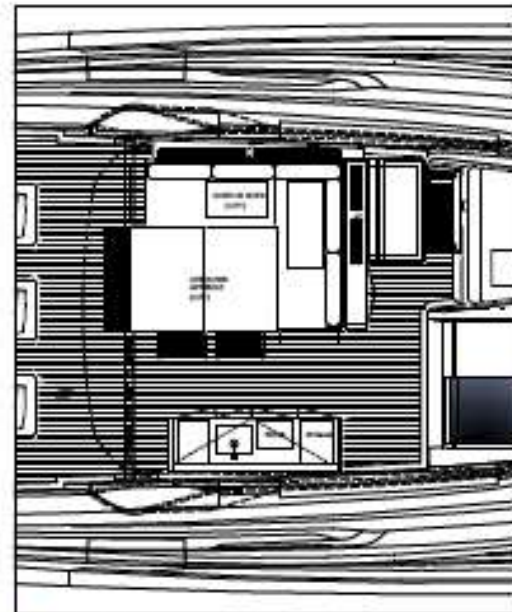
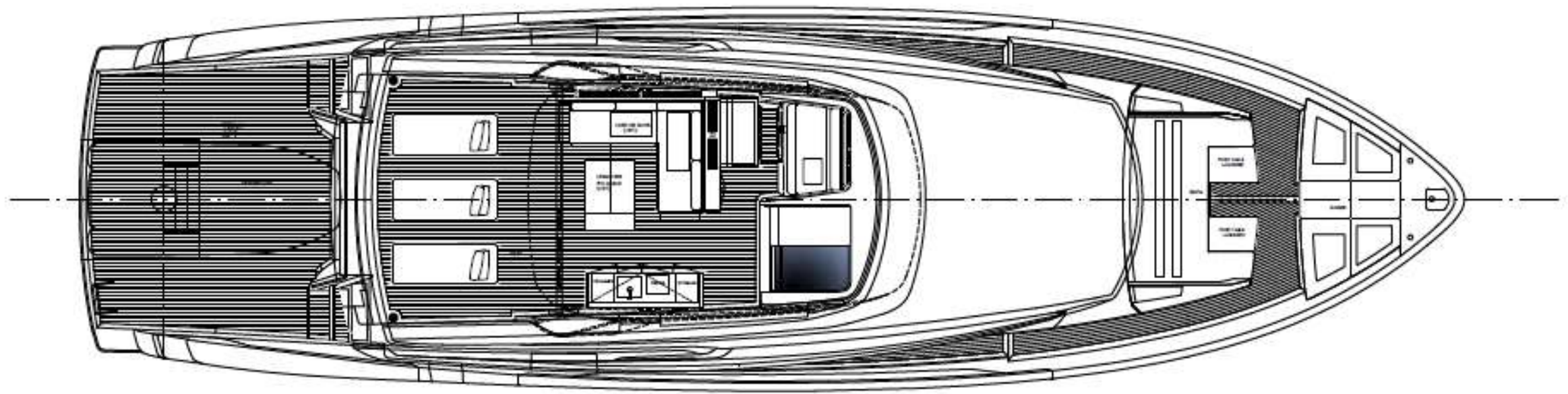

Flying bridge open table

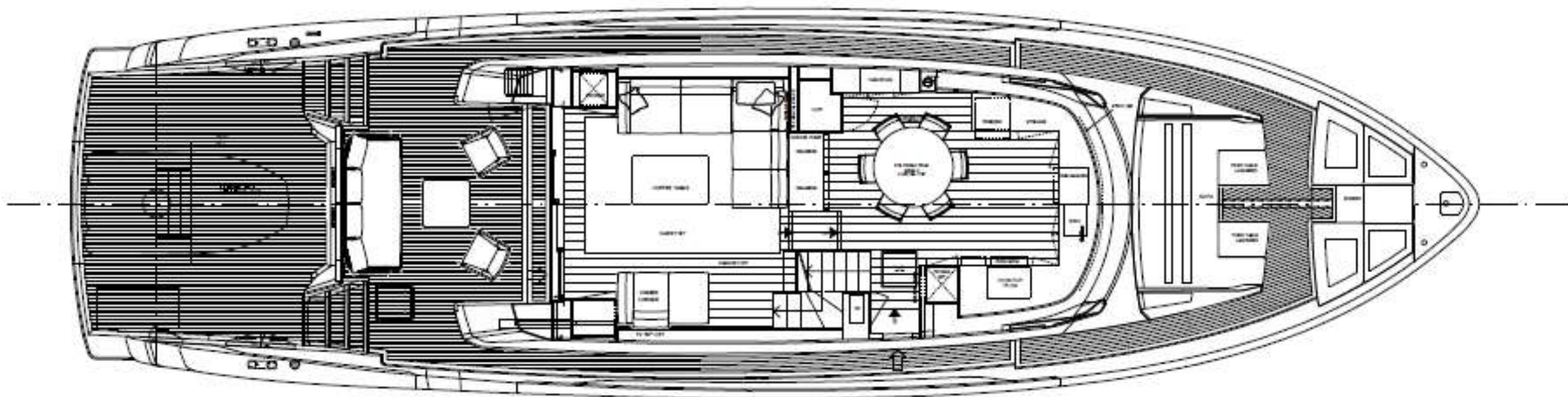

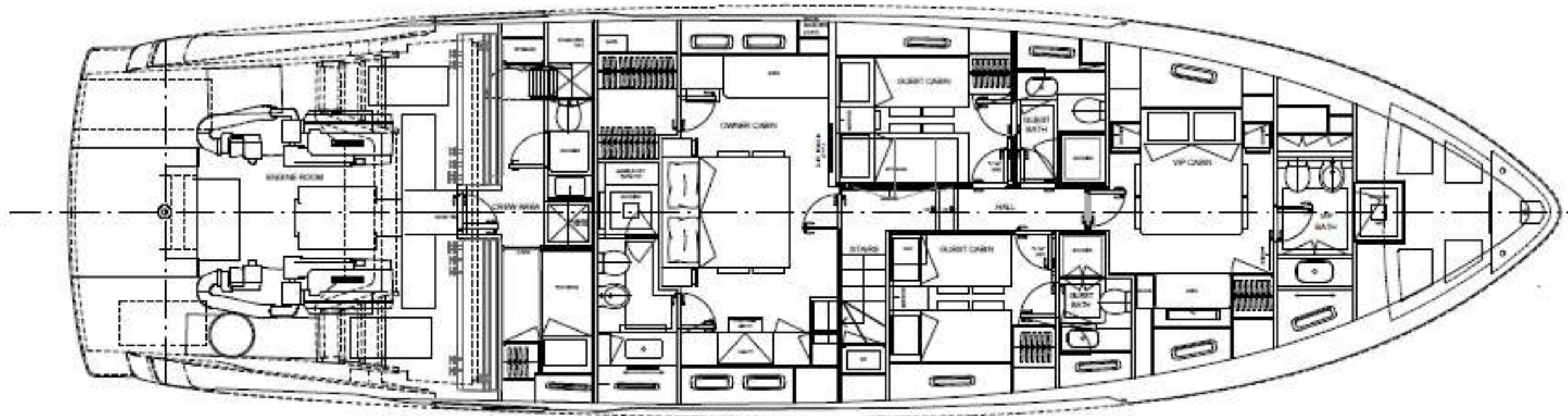

Option List

ELECTRICAL SYSTEM	
1	12V 25A battery charger for generators batteries
2	No. 2 additional waterproof sockets: no. 1 on flybridge bar, no. 1 USB in helm station
ALARMS AND CONTROLS	
3	CCTV IP Raymarine (no DVR): 2 fixed in cockpit, 2 fixed in engine room
4	Predisposition for additional Raymarine 12" touch screen monitor (ship monitoring system with empirbus) in crew mess
5	Raymarine integrated dashboard system (ship monitoring) including third additional Raymarine monitor
6	Raymarine diamond navigation package (diff. from standard)
SATELLITE AND COMMUNICATION SYSTEMS (TV SAT)	
7	TV-Sat Antenna KVH TV6
8	Empty Radome KVH TV6
AUDIO AND VIDEO APPLIANCES*	
9	Predisposition 5G Wi-Fi system with harbour hot spot antenna
10	Audio-video silver package
11	TV 43" in owner's cabin (diff. from standard)
12	TV 50" in salon (diff. from standard)
13	TV 24" in guest cabins
APPLIANCES	
14	Cooktop 80 cm Miele (diff. Ftom Standart)
INTERIOR ACCESSORIES	
15	Headshower in vip cabin
16	Parquet in salon and kitchen (diff. from standard)
17	Main deck openspace layout (custom dining table included)
18	TV behind fume stopsol mirror in owner's ccabin (diff.from standart)
19	Manuel roller black out curtains in owner's cabin (tot no:2)
20	No. 2 custom TV cabinets in guest cabins
21	No.1 additional rug fin.Santushi Starlight
22	No. 1 Flexform Este coffee table in salon, 130x80 cm, with Carrara marble polished finishing top and polished chrome structure
23	No. 1 " L" shape Sofa & Chaise longue in salon Flexform Soft Dream in standart fabric cat. Top and sadle leather
24	No. 8 Poltorna Frau Fitzgerald upholstered in leather
25	No.1 pouf in owner's cabin B&B Mirto with structure in varnished 0259V metal and fabric upholstery
26	No. 2 Maset reading led light tubes in aluminium in each cabin (diff. from standard)
27	No. 1 shower wall in owner's cabin in Emperador light marble with "infinito" texture (diff. from standard)

Option List

EXTERIOR ACCESSORIES	
28	Electric blades opening roof for hard top
29	Sun awning for the stern area of the flybridge behind the hardtop
30	Teak floor on flybridge
31	Side windows of the flybridge with electric opening system
32	Teak floor for beach area
33	Backlit boat name predisposition
34	Air conditioning on flybridge (including additional custom cabinet)
35	Predisposition for no. 4 underwater lights: no. 2 in aft transom, no. 2 on each side
36	Swimming platform lifting system
37	Custom dining sofa on flybridge in varnished teak structure and Roda Park K09 Steel fabric (diff. from standard no.8 chairs)
38	Electric up / down folding table on flybridge (diff. form standard)
THRUSTERS AND STABILIZERS	
39	Volvo joystick for engines IPS transmissions - second cockpit station
40	Electric stabilizers (at anchor and under navigation)
ENGINE ROOM EQUIPMENT	
41	Idromar 180 l/h watermaker
42	Additional second 28kW generator
43	Upgrade Tropical air conditioning system (diff. form standard)
ADDITIONAL ITEMS REQUESTED BY THE CLIENT	
44	Sun awning for bow area
45	Manuel high low table with cushions for transormation to sun bed in bow area
46	No.2 additional chain lenght tot 150m
47	Electric hi-low foldable table 100 x 200 cm open , 100 x 100 cm closed, in aft cockpit
48	Bow area sofa with manual foldable backrest for lounge transformation
49	No.1 predisposition for underwater light on centerline stern transom



FOR FURTHER INFO

Mrs. Nalan Okuyucu

+90-533-776-6030 | nalan.okuyucu@triodeniz.com

The decorative items shown in the brochure, as artworks, ornaments, towels, linens and bed covers were on board for the photo shooting only and they are not part of the offer.